

Sapphire™ Room Controller

Customizable lighting, color tuning and scheduling



DESCRIPTION

Sapphire™ Room Controller provides the flexibility of a fully customizable user interface with the convenience of native controls from Leviton's Commercial Systems products. Integrate room controls, including occupancy/vacancy sensing, partial-ON and partial-OFF from one elegant interface. Sapphire Room Control is Leviton's premier touch screen offering occupancy/photocell sensing, full-range automatic dimming, color tuning and daylighting integration. The scheduler feature allows facility and building managers to schedule holidays and daily lighting schedules from the touch screen.

SAPPHIRE LCD APPLICATIONS

- Color tuning— 0-10V, DMX
- Conference room control
- Building supervisor control panel
- Classroom control
- Executive office control
- Ballroom control
- Anywhere touch-interface is desired

FEATURES

- 7" capacitive touch screen
- Direct control of Leviton Hi-Fi over Ethernet
- Direct control of Leviton Switcher/Scaler over Ethernet
- User interface components
 - Tabs/pages
 - Buttons
 - Sliders
- Touch screen status updated from actual device status
- LumaCAN® connectivity
- Secure password protected administration
- Online/offline configuration and screen design through PC Tool
- Software & configuration updates through front panel USB memory stick
- Available faceplates: White, Light Almond, Black

SCHEDULER DETAILS

- 7 day scheduler
- (2) custom, user defined holiday exception calendars
- Astronomical time clock
- Special event calendar

ROOM CONTROLLER DETAILS

- (2) low voltage/analog inputs for connecting of occupancy sensors, photocells, etc.
- Receives input signals for automatic dimming and daylighting within the space
- Allows for closed loop daylight harvesting

BUTTON DETAILS

- Button operating modes
 - Toggle
 - Press/release
 - Preset group
- Configurable caption
- All network commands supported

SLIDER DETAILS

- Configurable caption
- Supports only set channel/group level commands
- Configurable numeric level display

NETWORK COMMANDS

- Administrative functions
 - Network setup
 - Log file import/export
 - Configuration update
 - Snapshot record
 - Snapshot edit
- Set channel and group level
- Fade stop
- Room combine/separate
- Fade rate or fade time
- Raise/lower
- Turn audio zone ON/OFF (Hi-Fi)
- Set audio zone level (Hi-Fi)
- Select audio zone source (Hi-Fi)
- Select video source (Switcher/Scaler)
- Projector ON/OFF (BC4)

PRODUCT BULLETIN

SAPPHIRE USER INTERFACE SCREENSHOTS

Daily View

Daily View + ⋮

May 6, 2016 Weekly

5AM		12PM	
6AM		1PM	
7AM		2PM	
8AM	Lights On	3PM	
9AM		4PM	
10AM		5PM	Lights Off
11AM		6PM	

Daily

Schedule Creator

⊗ ✓ ⋮

Event Name
Lights Off

Event Type
Weekly

Offset
None

Time
17:00

Repeat
Every Day

Command

Event

Holiday List

HOLIDAY 1 + ⋮

December 25

January 1

First Tuesday of April

Holiday

WIRING DIAGRAM

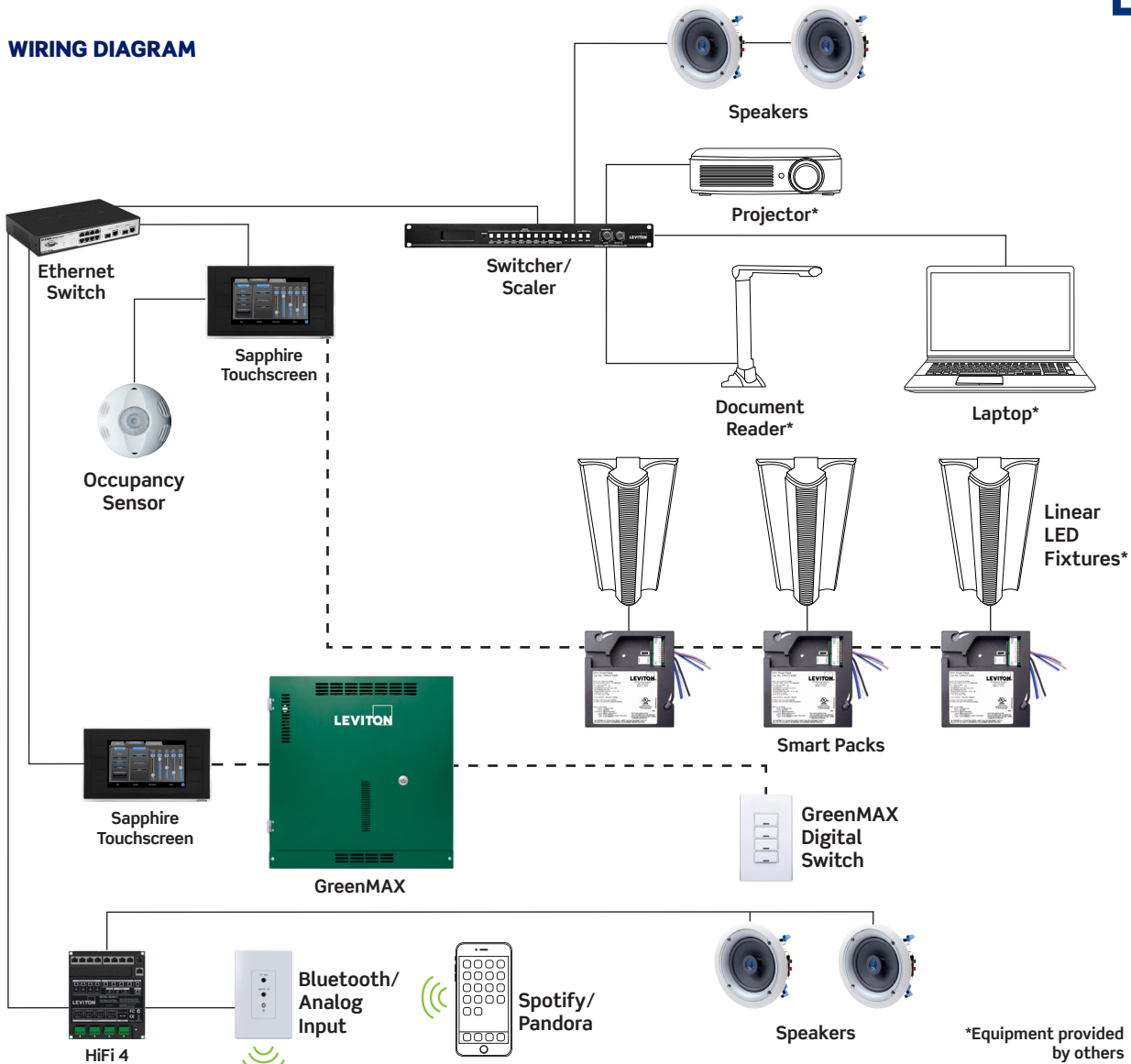

TOUCH SCREEN WITH CONNECTOR ANNOTATIONS - REAR VIEW

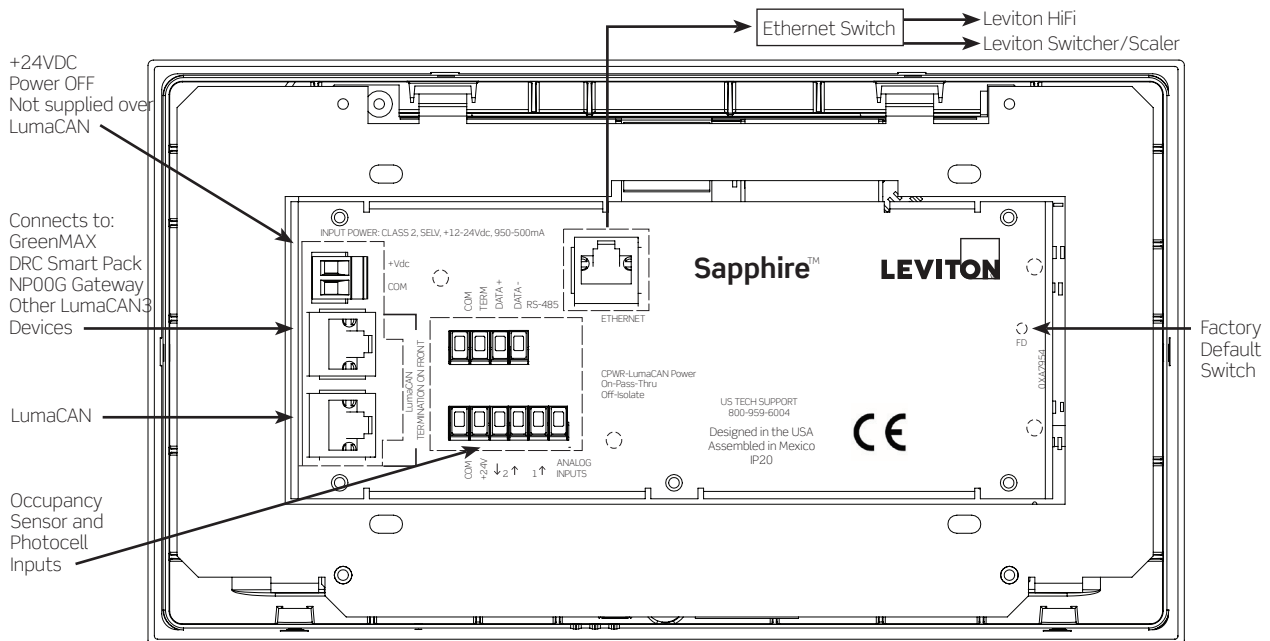

Leviton Manufacturing Co., Inc. Global Headquarters

20497 SW Teton Avenue, Tualatin, OR 97062 tech line 800-959-6004 fax 503-404-5594

©2018 Leviton Manufacturing Co., Inc. All rights reserved. Subject to change without notice.

PRODUCT BULLETIN



INSTALLATION DIAGRAM

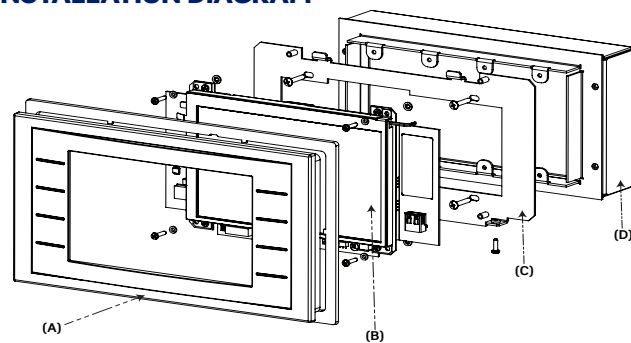

A	Face plate with trim ring
B	Touch screen electronics
C	Normalizing installation & mounting
D	4-gang box

DIMENSIONS

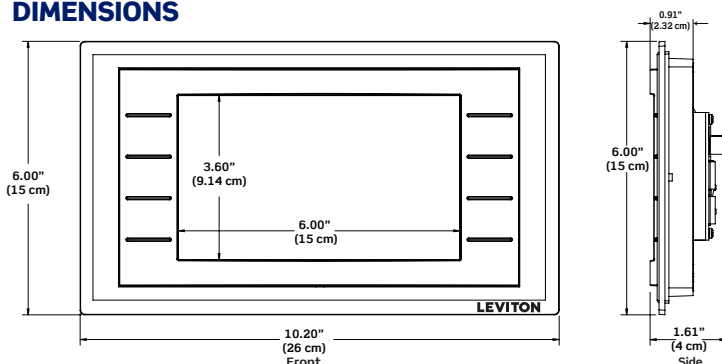

SPECIFICATIONS

LCD Panel	7" (17.78cm) diagonal, 16.9 form factor ; 800x480 WVGA; 130° x 110° viewing angle; LED backlight; 24 bit color
Power Input Voltage	+12-24VDC, Class 2 SELV; 200mA standby current, power supply via terminals or LumaCAN network
Environmental	Operating Temperature Range: 14 to 122°F (5 to 50°C) Storage Temperature: -4 to 158°F (-20 to 70°C) Relative Humidity: 0 to 90° non-condensing
Enclosure	Mounting/installation: 4-gang box with a 4-gang raised device cover preferred, 4-gang low voltage rating acceptable, IP30
Listings	CE, NOM, FCC

ORDERING INFORMATION

CAT. NO.	DESCRIPTION
TS007-000	7" Touch Screen, capacitive interface, no faceplate included
TS007-C0E	7" Touch Screen Color Change Kit, Black faceplate
TS007-C0T	7" Touch Screen Color Change Kit, Light Almond faceplate
TS007-C0W	7" Touch Screen Color Change Kit, White faceplate
TS007-LCE	7" Touch Screen Locking Cover, Black
BBG04-000	4 gang box
WPG04-DR0	4 gang raised device ring for use with BBG04-000
PST24-I10	+24Vdc, 1A, 30W 100-277VAC Input DIN Rail Power Supply. UL, cUL & CE listed, terminals on input and output

Leviton Manufacturing Co., Inc. Energy Management, Controls and Automation

20497 SW Teton Avenue, Tualatin, OR 97062 **tel** 800-736-6682 **fax** 503-404-5594 **tech line** (6:00AM-4:00PM PT Mon-Fri) 800-959-6004

Leviton Manufacturing Co., Inc. Global Headquarters

201 North Service Road, Melville, NY 11747-3138 **tel** 800-323-8920 **fax** 800-832-9538 **tech line** (8:30AM-7:00PM ET Mon-Fri) 800-824-3005

Visit our Website at: www.leviton.com/sapphire

©2018 Leviton Manufacturing Co., Inc. All rights reserved. Subject to change without notice.

G-10202/A18-tb
REV JAN 2018